

Alertex Air Safe vape sensor

Quick Start Guide

1. Unpack

- Vape sensor
 - Screws/wall plugs
 - RJ45 cable
 - 12-volt DC power adaptor
 - QR code / device ID label
-

2. Install the Sensor

1. Choose a location on the **ceiling or high on a wall** (avoid vents, fans, and windows).
 2. Use the backplate as a template; install with provided screws/wall plugs.
 3. Connect a PoE RJ45 cable. No requirement for the 12-volt power adaptor.
 4. Alternatively connect an RJ45 ethernet cable plus the 12-volt power adaptor.
 5. For Wi-Fi operation, just connect the 12-volt power adaptor
 6. Place the sensor onto the backplate and fit the four securing screws provided.
-

3. Power Up

- Once power is provided to the sensor it will become active and findable on the local network using the Alertex dedicated pc or mac app.
- Alternatively you can also scan for it using a BLE terminal. Downloadable from via the app store.

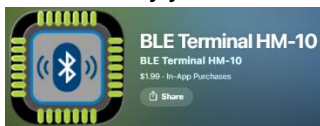

- For Android there are many other options



- Scan for devices, Pair with the selected unit
- Enter the password 123456
- Enter your Wi-Fi DNS name as Wi-Fi=#### and password; #### EG: Wi-Fi=wxyz;QqRrTt765
-

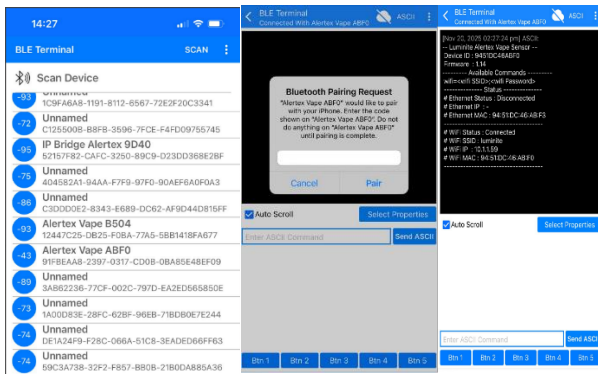

4. Loading PC and MAC alert Apps

1. Scan the QR code in the product to download the notification app on any admin computer
2. The icon will display on the bottom right corner of the screen



3. Right click on the icon and select “Devices”
4. Found devices will display like this

Connected Devices

Devices on Network

Device Name	Device ID	IP Address	Type	Last Seen
Alertex-Vape	9451DC4796D4	10.1.1.60	NX-VAPE	just now
Alertex-Vape	9451DC46ABF0	10.1.1.59	NX-VAPE	just now
Testing	2043A840B504	10.1.1.45	NX-VAPE	just now

5. Click on the IP address to go to the units web page

Luminite Vape Sensor
Alertex Monitoring

Monitor Alarms

Integrations

Settings

- 6.

5. Let It Calibrate

- Allow the device **10–15 minutes** for initial stabilization.

6. Test Detection (Optional & Only Where Allowed)

- Trigger a short, controlled test puff from an e-cigarette within **2.75 meters** from the sensor.

Notifications

- Notifications will appear on any computer running the app and display like this



7. You're All Set

- Adjust sensitivity in the app (Low / Medium / High).
- Enable push or email notifications.

Check event logs anytime.

Alertex Safety Products

www.luminite.co.uk | info@luminite.co.uk | +44 (0)20 8368 7887